

bebello

washer

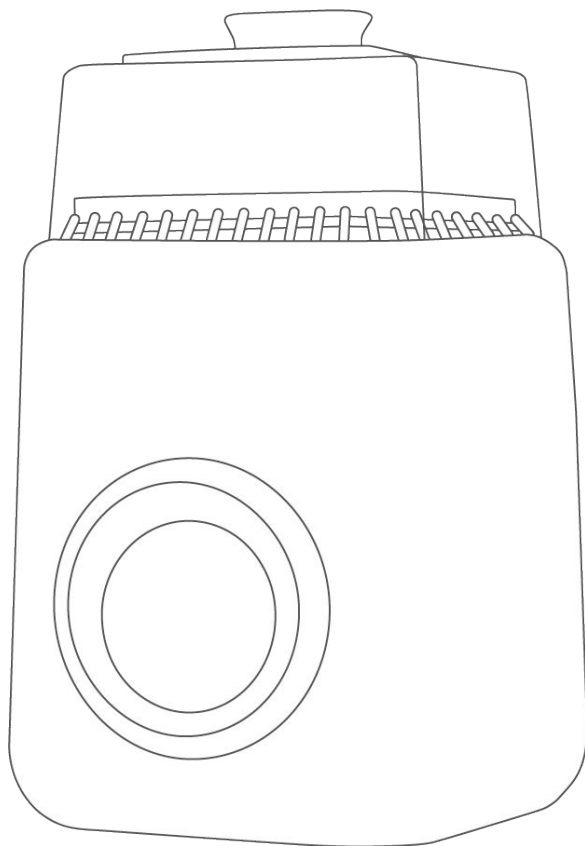

Instruction Manual

bebello.club

Please read this user manual carefully before you use the Washer and save it for future reference.

Danger

1. Never immerse the Washer, the Power Cord or the Plug in water or any other liquid.
2. Never disassemble the Washer to avoid the risk of electric shock.

Warning

1. This Washer can be used by persons with reduced physical, sensory or mental capabilities or lack of experience and knowledge if they have been given supervision or instruction concerning use of the Washer in a safe way and if they understand the hazards involved.
2. Children shall not touch, operate or play with the Washer. The Washer creates steam which can cause scalding.
3. Check if the voltage indicated on the Washer corresponds to the local mains voltage before you connect the Washer.
4. Do not use the Washer if the Plug, the Power Cord or the Washer itself is damaged. If the Power Cord is damaged, it must be replaced by the manufacturer, its service agent or a similarly qualified person in order to avoid a hazard.
5. There are no user-serviceable parts inside the Washer. Any servicing should be undertaken by an authorized service representative. Do not attempt to open, service or repair the Washer by yourself.
6. Beware of hot steam that comes out of the vent in the Lid or when you remove the Lid. Steam can cause scalding.
7. Do not touch the base, the Trays and the Lid during or shortly after sterilisation because they are very hot.
8. Never move or open the Washer when it is in use or when the water in it is still hot.
9. Never place items on top of the Washer when it is in use.
10. Only use water without any additives.
11. Do not put bleach or other chemicals in the Washer.
12. Only use baby bottles, pumping parts or other items that are suitable for dishwashers and steam sterilisation. Check the user manual of the items you want to clean and sterilise, to make sure they are suitable for dishwashers and steam sterilisation.
13. This Washer is intended for indoor household use only. Do not use outdoors.

Caution

1. Do not expose the Washer to extreme heat or direct sunlight.
2. Always let the Washer cool down before you move or store it.
3. Unplug the Washer from the power supply before cleaning or storage.
4. Do not sterilise very small items which can fall through the holes in the Lower Tray. This may prevent the lower spinner from rotating.
5. Do not use the Washer if it has fallen or is damaged in any way. Take it to an authorised service centre for repair.
6. Always place and use the Washer on a dry, stable, level and horizontal surface.
7. Do not place the Washer on or near hot surfaces, or near a gas or electric heater.
8. Do not let the Power cord hang over the edge of the table or worktop on which the Washer stands.
9. If not using for a period of time, or planning to return the Washer, pour any remaining water out of the Washer after use and when the Washer has cooled down.
10. Environmental conditions, such as temperature and altitude, may affect the functioning of this Washer.
11. Cleaning and user maintenance shall not be made by children.
12. Always disconnect the Washer from supply if it's left unattended.
13. Regular descaling is required in hard-water areas to maintain performance. Failure to follow the descaling instructions may cause irreparable damage.
14. If a wash or sterilise program is stopped by pressing the Power button, please allow the Washer to complete its drain cycle to ensure all water is ejected, before unplugging.
15. Only add water to the Water Tank. Do not add water directly to the Washer Cavity as this will lead to suboptimal performance.
16. Keep the air filter on the base free of blockages to ensure efficient drying.
17. If opening the Lid during a program, press pause first to limit the opportunity of water to escape.

The Bebello Washer is Intended for use indoors; in residential homes, hotels and other similar lodging and offices/office break rooms or nursing rooms.

The Washer might arrive with trace amounts of water inside. This is from quality checks undertaken before shipping.

When you use the Washer for the first time, we advise you to let it complete one clean cycle with empty Trays.

Contents

5	Environmental sustainability
6	Washer parts
7	Control panel & Washer programs
8	First-time setup
9	First-time use
10	Setting up for optimal cleaning results
11	Part Loading
12	Lower Tray - loading suggestions
13	Upper Tray - loading suggestions
14	Detergent Advice & Dosing
15	Lower Tray - intensive cleaning zones
16	Cleaning & maintenance
17	Error Codes & troubleshooting
18	Technical Specifications

Environmental sustainability

Heating water - the basics

Heating water is the most energy intensive activity we do in our homes - for warmth, washing, cooking and cleaning. Most water is heated by burning gas in a boiler, which contributes to around 1/3rd of the UK's Carbon footprint.

Our research shows that most parents wash feeding bottles and pumping parts with the hot tap running. The average parent will spend 45 to 60 minutes per day handwashing baby parts. The water used is equivalent to nearly a bathtub full of hot water per day. If that water is heated by a gas boiler, it creates a lot of CO₂ (carbon).

Saving energy with the Bebello Washer

The Bebello Washer replaces the energy-intensive process of handwashing, saving vast amounts of water and energy in the process.

The Bebello Washer uses electricity to heat the water for cleaning and sterilisation. If that electricity comes from renewable sources such as wind or solar, the energy used is practically carbon free.

The positive environmental impact of the Bebello Washer can be maximised by doing the following:

1. Ensure your electricity supply is as clean as possible. We suggest switching to a 'green' tariff to ensure your electricity comes from renewable sources.
2. If you have a large south-facing roof on your property, you may consider installing solar panels which are now dramatically cheaper to instal than in previous years.
3. Use the washer for full loads as much as possible.

'Clean' electricity

Octopus Energy is a fantastic UK based energy supplier at the forefront of the clean-energy revolution. Their electricity is from 100% renewable sources, and If you switch to them using the code below you will get you a £50 discount!

share.octopus.energy/aglow-kudu-475

Grant funding

Grants and low-interest loans funded by the government are available to help pay for solar panels and other energy efficiency improvements across the UK.

Extra detail & continue the conversation

More detail on energy-use, carbon and sustainability can be found on the sustainability section of the Bebello website. We want to hear from you on our approach, so please continue the discussion and provide suggestions & feedback on our socials.

Washer parts

1. Lid
2. Upper Tray
3. Lower Tray (with Spray Arm)
4. Washer
5. Washer Cavity
6. Micro Spinner
7. Control Panel
8. HEPA Filter
9. Filter Cover
10. Tank Lid
11. Water Tank
12. Drain Tube
13. Power Cord

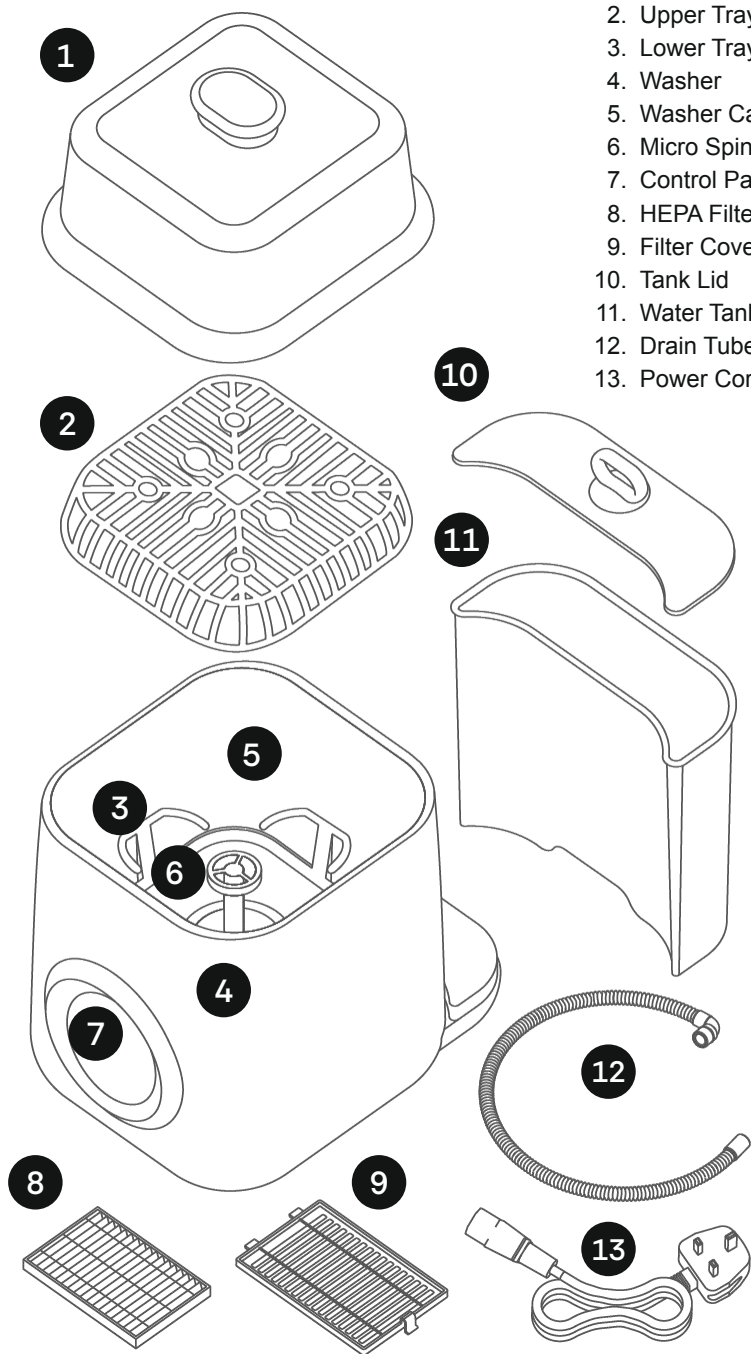

Control panel

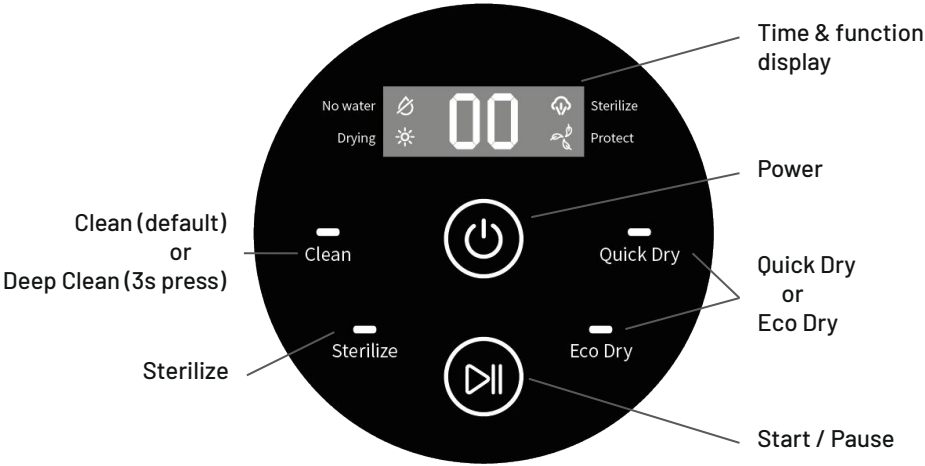

A flashing 'No Water' symbol indicates there is not enough water to complete the program, so the the Water Tank tank needs to be refilled with water.

Washer programs

	Duration	Water used	Energy use (kWh)
Clean	19 mins	2.2 L	0.12
Deep Clean*	29 mins	2.2 L	0.19
Sterilize	10 mins	0.25 L	0.09
Quick Dry	45 mins	-	0.10
Eco Dry	120 mins	-	0.02
Protect	72 hours	-	0.07

Deep Clean is a longer and more intensive wash cycle, to be used for stubbornly dirty parts, activated by pressing 'Clean' for 3 seconds.

Quick Dry is a heated drying cycle. Eco Dry is un-heated drying cycle which takes longer, but uses 5x less energy.

The Protect cycle engages automatically after the last program is finished. It replaces the air inside the washer once every hour keeping parts dry, sterile and ready-to-use. (Dry and Protect functions draw air through the HEPA filter).

First-time setup

Where to use the washer?

A flat, stable work-surface near a sink such as the kitchen, utility room or bathroom, is the perfect home for the washer.

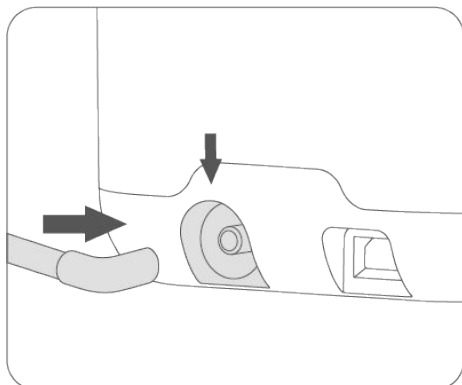

Push fit the Drain Tube so that the tube faces the direction of the sink.

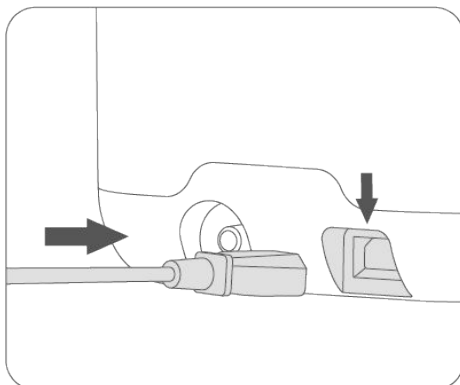

Press the Power Cord into position firmly for a good connection.

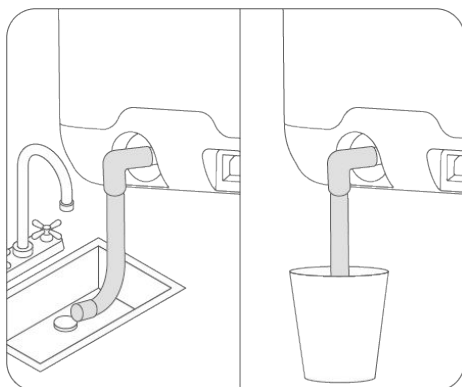

Position the Drain Tube so that water can drain into a sink, or a bucket (with capacity over 2.5L)

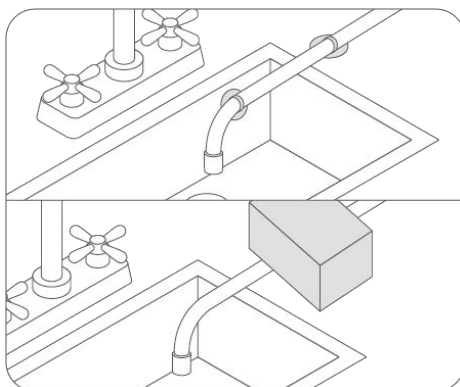

Hold the Drain Tube in position by ensuring both suckers are firmly attached to a polished surface.

If available surfaces are textured, we advise using a weight to hold the tube in position.

First-time use

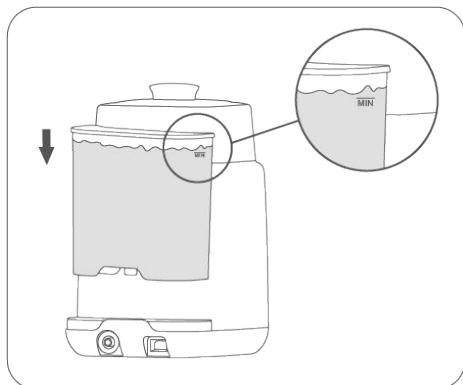

Fill the Water Tank above MIN line.

1. Fill the Water Tank with tap water to above the MIN fill line. (Use the Tank Lid to help prevent spills).
2. Fit the Water Tank securely to the Washer.

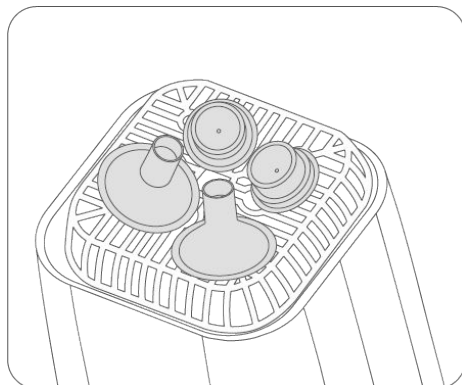

Load Parts onto Trays

Fully disassemble the parts to be cleaned, then position onto Washer Trays.
(See loading suggestions on the following pages).

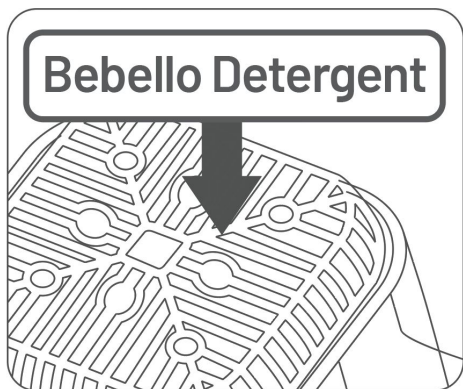

Add Detergent

Add detergent directly into the Washer Cavity.

See P14 for dosing recommendation.

Do NOT add detergent to the Water Tank.

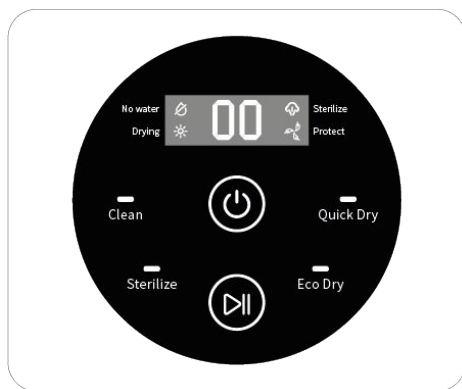

Select Programs & start!

1. Turn the Washer on by pressing the Power button.
2. Select the program or program combinations you want to use. (The countdown timer will display the time taken to complete your chosen programs).
3. Press Start and watch the magic happen!

Setting up for optimal cleaning results

How you use the washer is up to you, but following these tips will help guide you to success more quickly

Suggested cleaning locations for optimal cleaning, sterilising and drying:

Bottom Tray	Upper Tray
Large & Small bottles	Small & fiddly bits from pumps Seals, valves, diaphragms
Breastshields	Small bottles
Bottle teats	Anti-colic straws
Bottle caps	Dummies & Soothers
Silicone Breast Pumps	Teething toys

Part Loading

Suggested Part Orientation for optimal cleaning, sterilising and drying:

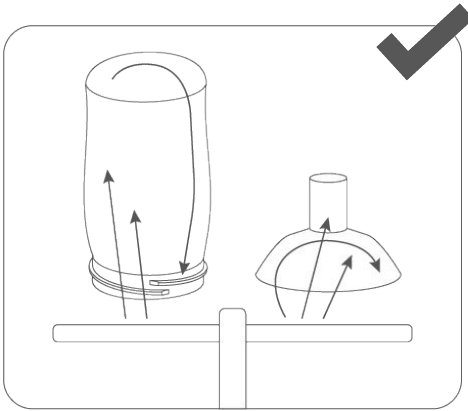

Do: Place the dirty sides 'facing down'

Place dirtiest sides facing down towards the water jets. This will give optimal cleaning and allow the water to drain out and make drying quicker.

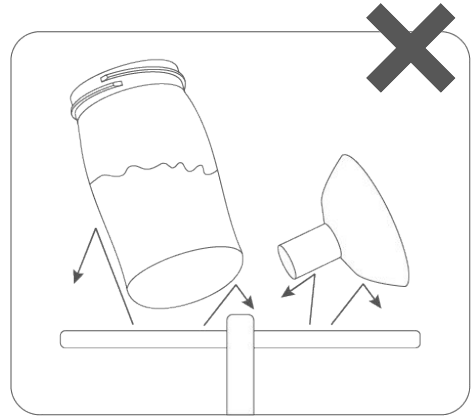

Do NOT: Place the dirty sides facing 'away' from the water-jets

This 'hides' the dirty sides from the water jets, reducing cleaning effectiveness and letting water pool.

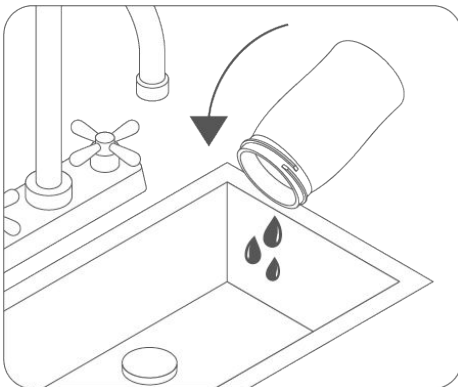

Shake off excess milk before loading

Shake excess milk into the sink before putting parts in the washer.

This reduces the amount of milk the washer needs to remove, and maximises cleaning power.

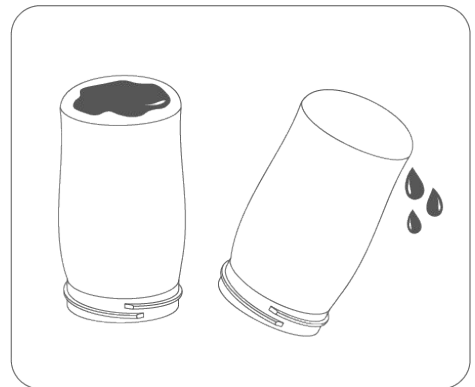

'Tip' bottles to improve drying

Most bottles have concave bases that collect water.

Slightly tipping the bottles will encourage the water to run out to optimise drying time.

Lower Tray - loading suggestions

The Lower Tray is set up to hold 4 feeding bottles by default.
It is also great for larger parts such as breastshields & silicone breast pumps.

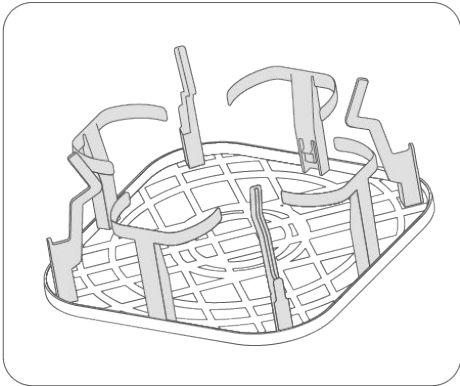

Lower Tray - as supplied, with 4 Bottle Holders and 4 Teat Holders.

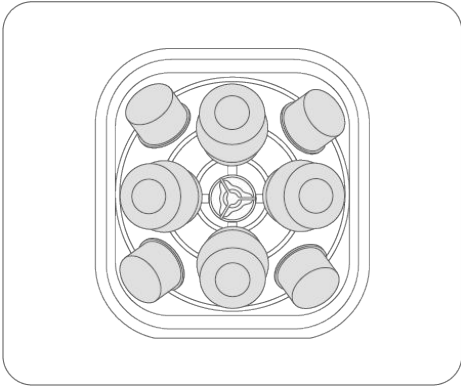

Lower Tray loaded with 4x bottles and teats in the corner

The Lower Tray can be adjusted to accept up to 8 feeding bottles.

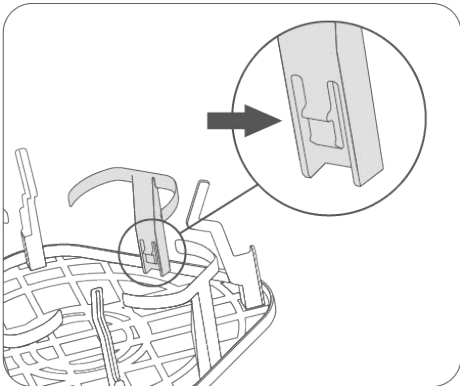

Depress the fasteners to remove the Bottle Holders and / or Teat Holders

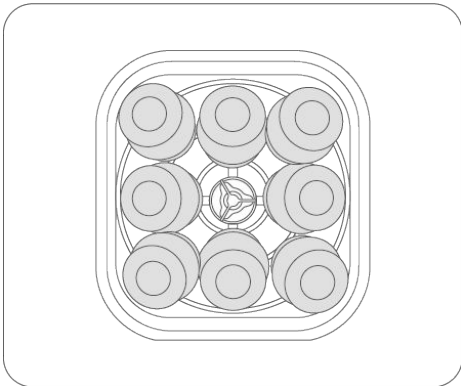

With the Holders removed, 8 bottles can be loaded as shown.

NOTE: If 8 bottles are loaded in the Lower Tray, bottle teats will need to go on the Upper Tray.

Upper Tray - loading suggestions

The Upper Tray can be installed in two ways to maximise cleaning capacity:

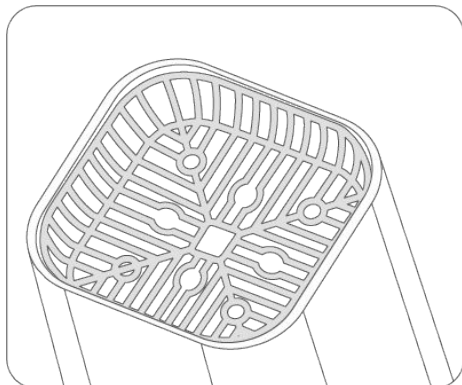

If short bottles are placed on the Lower Tray - place the Upper basket as shown.

This setup provides more space for bigger items on the Upper Tray.

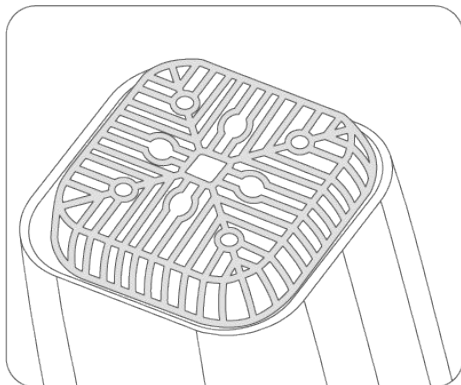

If tall bottles are placed on the Lower Tray - place the Upper basket as shown.

This setup provides clearance for the tall bottles below.

Suggested part placement for selected parts

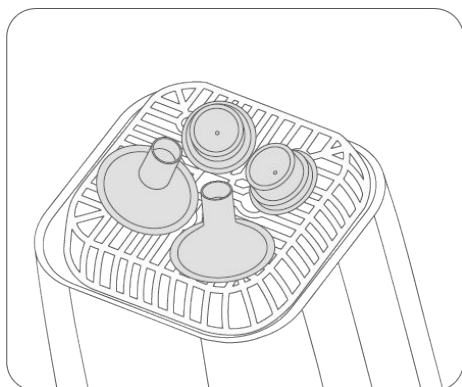

Orient dirty sides to face downward.

Try not to overlap parts as this may block access to the water jets.

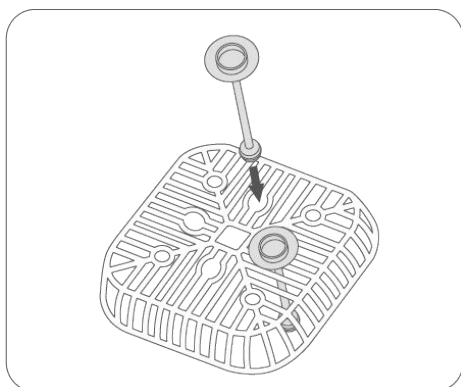

Anti-colic straws should be placed through the retainer holes in the Upper Tray to allow maximum water access.

Detergent Advice & Dosing

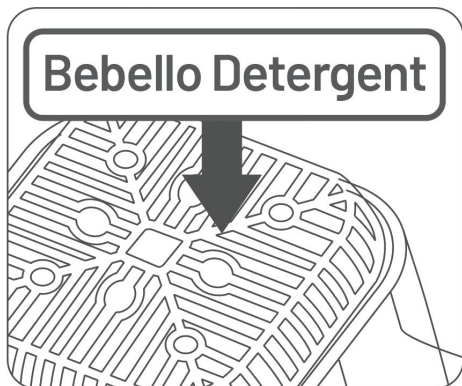

Recommended Detergent Dosing

The Washer is optimised for use Bebello detergent. Add directly to Washer Cavity.

If using other brands of detergent we suggest:

1x Teaspoon of liquid dishwasher detergent (3-5ml), or
1x teaspoon (3-5g) of dishwasher powder, or
 $\frac{1}{2}$ of a small (10g) dishwasher tablet, or
 $\frac{1}{4}$ of a regular (20g) dishwasher tablet.

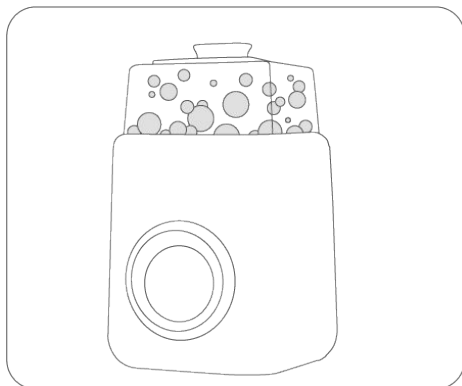

Do not use washing-up liquid!

Washing-up liquid has a foaming agent that creates excess bubbles.

The excess bubbles prevent the spray arms rotating, severely reducing cleaning effectiveness.



Drying Marks

You may notice some small 'water marks' left on parts after a drying cycle.

These marks are the outlines of dried water droplets. This phenomenon is seen more frequently in 'hard-water' areas where the mineral content of the water is higher. These marks can be wiped off with a cloth if required.

Lower Tray - Intensive cleaning zones

The Lower Tray has some extra features that allow you to orient parts directly at 4 water jets to provide a more targeted clean of stubbornly dirty parts.

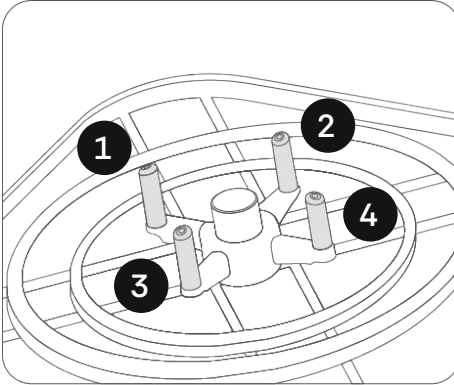

In addition to the a rotating spray arm, the Lower Tray has 4 high-intensity water jets.

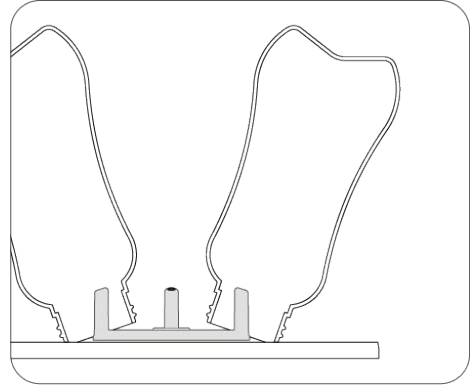

Place especially dirty bottles or parts over these for a more intensive clean.

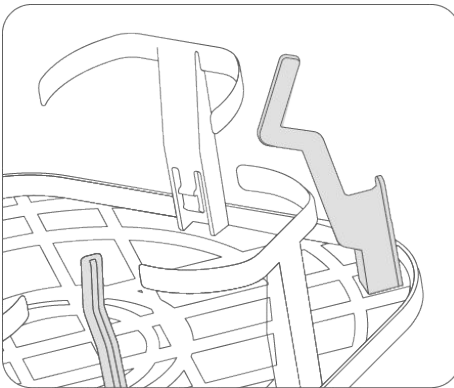

There is a teat holder in each corner of the Bottom Tray. These are angled to optimise water access to the inside of the teat.

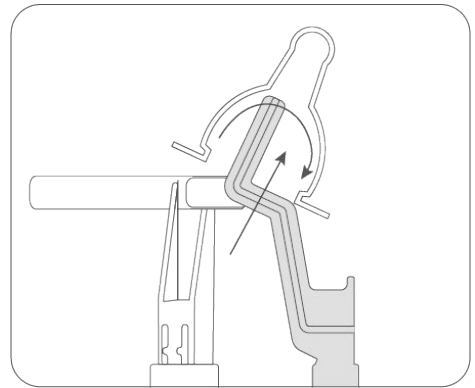

This is the suggested positioning for teats on the Lower Tray.

Cleaning & maintenance

Essential for good performance: Descaling

If you live in a hard-water area (majority of UK population) we recommend descaling every 2 weeks to maintain optimal performance.

(Your water area can be confirmed by searching: "Water Hardness Postcode Checker").

Option 1: Bebello Descaler

Follow instructions on product.

Option 2: DIY - Do It Yourself

1. Pour 200ml of White Vinegar (5% acetic acid) and 200ml of water into the main Washer Cavity. (Not the Water Tank).
2. Allow mixture to rest for 8 hours (or overnight) in the Washer Cavity.
3. Run a 'Clean' cycle with fresh water from the tank to flush out the vinegar & limescale.
4. The Washer is ready to use again.

If you live in a soft-water area, we recommend following the above procedure once every month to ensure the heating element is kept clean.

You can also use citric acid based descalers. Do **not** use other types of descaler.

Cleaning the Washer

The Washer can be kept clean with a damp cloth, and normal washing-up liquid if required. The Trays and the Lid can be cleaned with hot water and some washing-up liquid.

Do not use abrasive or aggressive cleaning agents (e.g. bleach) or a scouring pad to clean the Washer, as this may scratch the surfaces.

Never immerse the base, the Power Cord or the Plug in water or any other liquid.

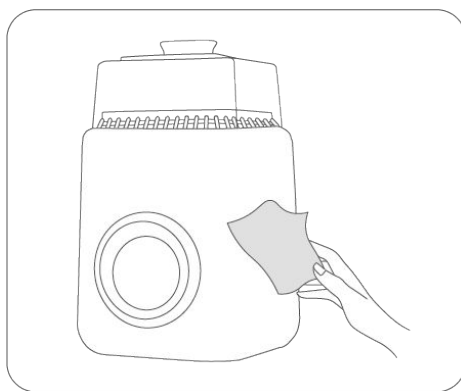

Error Codes & Troubleshooting

Error code	Fault description	Proposed solution
No-water light flashing	Informing you there is not enough water in the Water Tank to perform the desired function.	Fill the Water Tank, then ensure the Lid is in position and press the Start button. The system will pull the correct amount of water into the Washer to run the desired program.
	If repeated warnings, despite presence of water in the Tank, then:	Likely to be a system failure. Please contact customer support for further troubleshooting.
E4	Water temperature sensor error	Restart the Washer by turning off the machine at the wall, and then back on again after 5 seconds. If the issue persists, please contact customer service.
E5	Communication failure between Control Panel & Washer	
E6	Heating Error	

Issue	Possible cause	Proposed Solution
Too much foam in the Washer Cavity	Use of washing-up liquid, or excess detergent.	<ol style="list-style-type: none"> 1. Open Lid & scoop out the foam. 2. Fill Water Tank with water, then run Clean cycle without detergent. 3. Run next programs with the recommended detergent & dosing.
Rattling noises	Spray Arm touching parts	Check no small parts are poking through the Lower Tray and touching the Spray Arm.
	Lighter parts moving	The jets can be quite strong, so its normal that smaller, lighter parts may move around.
Excess water on inside of Lid	Condensation naturally forms on cold surfaces and is hard to prevent.	<p>If the condensation is an issue, we suggest</p> <ol style="list-style-type: none"> 1) trying the Quick Dry setting to evaporate most of the remaining water, or 2) leave the lid slightly open to allow more air to circulate freely to remove humidity.

Technical Specifications

Product Name	Bebello Washer
Model	Washer-220-01-01
Rated Power	530W
Frequency	50Hz
Tank Capacity	2.6L
Max bottle capacity	8
Net Weight	4.5kg

Specifications are subject to change without notice



Disposal



This symbol means that this product shall not be disposed of with normal household waste. Follow your country's rules for the separate collection of electrical and electronic products. Correct disposal helps prevent negative consequences for the environment and human health.

The end

You made it to the end - thanks for reading! 😊

bebello

bebello.club